



**AL FUTURO  
CI PENSIAMO NOI**



**STRUTTURE IN ALLUMINIO PER L'INSTALLAZIONE  
DI PANNELLI FOTOVOLTAICI**



Caratteristiche fisiche e generali dell'alluminio	Pag. 4
Scheda dati tecnici dei profilati	Pag. 5
Sistema di montaggio a inclinazione variabile	Pag. 6
Scheda dati tecnici dei profilati per gazebo	Pag. 7
Sistema di montaggio per gazebo	Pag. 8-9
Elenco profilati per strutture a terra mediante sottostrutture metalliche	Pag. 10
Sistema di montaggio fissato a terra	Pag. 11
Sistema di montaggio su sottostruttura metallica	Pag. 12
Elenco profilati per chiusure orizzontali	Pag. 13
Sistema di montaggio per chiusure orizzontali	Pag. 14
Accessori di tenuta	Pag. 15

I disegni e le descrizioni contenute in questo catalogo sono da intendersi in modo indicativo. I profilati contrassegnati col segno\* sono riservati.

Il catalogo è di proprietà di To.Ma. s.p.a. così come i suoi contenuti ed immagini.

To.Ma. s.p.a. declina ogni responsabilità su eventuali errori di stampa o sull'uso improprio del presente catalogo e si riserva la facoltà di modificarne il contenuto senza alcun obbligo di preavviso.

# Caratteristiche fisiche e generali

## Alluminio

EN AW-ALMgSi  
UNI EN 573-3 (6060)

### Composizione chimica percentuale

<b>Mg</b> Magnesio	<b>Si</b> Silicio	<b>Fe</b> Ferro	<b>Ti</b> Titanio	<b>Cu</b> Rame	<b>Cr</b> Cromo	<b>Mn</b> Manganese	<b>Zn</b> Zinco	Altri elementi max	<b>Al</b> Alluminio
0,35 - 0,60	0,30 - 0,60	0,10 - 0,30	0,10	0,10	0,05	0,10	0,15	0,05 - 0,15	Resto

### Caratteristiche fisiche e generali

Peso specifico	2,7 Kg/dm <sup>3</sup>	Calore specifico 0-100°C	≈0,92 J/(g x K)
Modulo di elasticità	66000 N/mm <sup>2</sup>	Coeff. di dilatazione teorico lineare 20-100°C	≈23 x 10 <sup>-6</sup> x K <sup>-1</sup>
Modulo di rigidità	26500 N/mm <sup>2</sup>	Conduttività termica a 20°C	≈1,75 W (cm x K)
Punto di fusione	605 °C	Resistività a 20°C ( T6 )	≈3,25 μΩ x cm

### Profilato estruso

Stato metallurgico	Dimensioni mm	Carico di rottura a trazione		Carico al limite di snervamento		Allungamento	
		$R_m$ MPa		$R_{p0,2}$ MPa		$A$ %	$A_{50mm}$ %
		min.	max.	min.	max.	min.	max.
T5	≤5	160	-	120	-	8	6
	5 < e ≤25	140	-	100	-	8	6
T6	≤3	190	-	150	-	8	6
	3 < e ≤25	170	-	140	-	8	6

ELENCO PROFILATI

BINARIO SEMPLICE

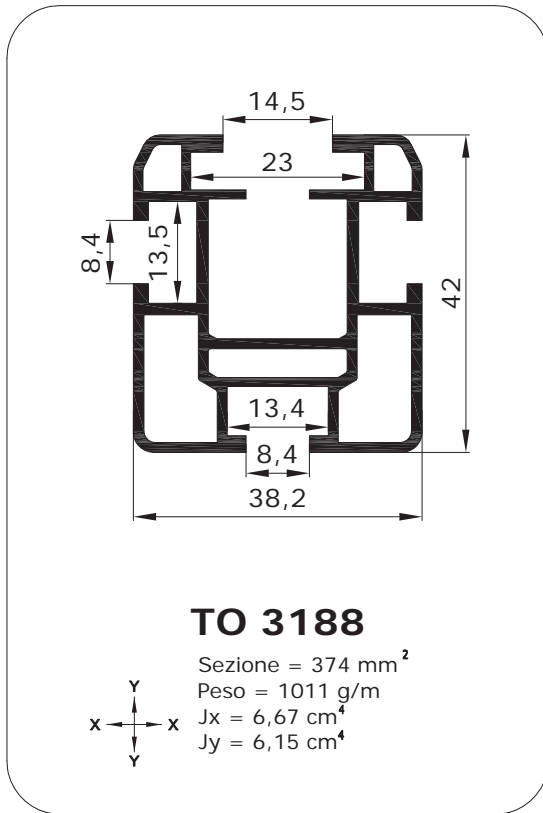

BINARIO PORTACAVI

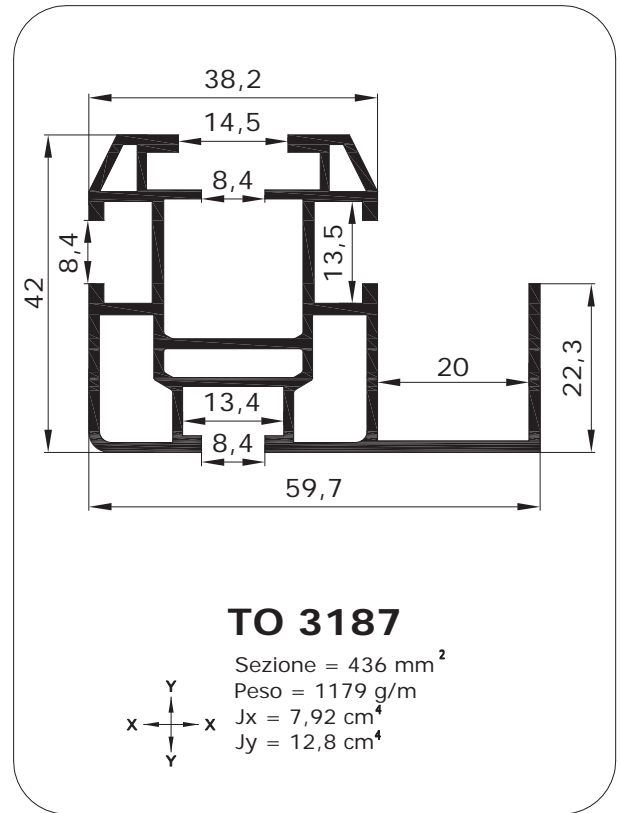

PROFILATI PER SOTTOSTRUTTURA

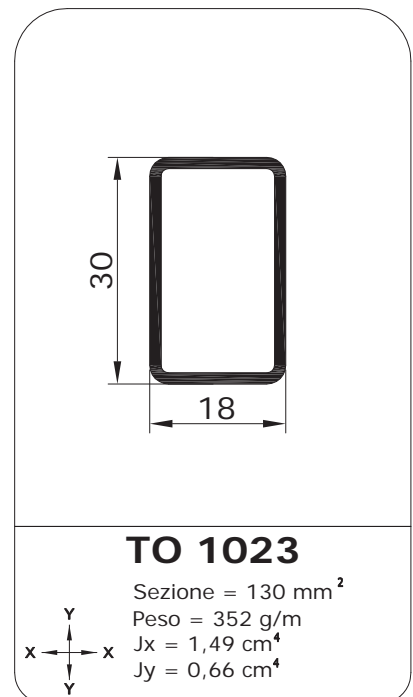
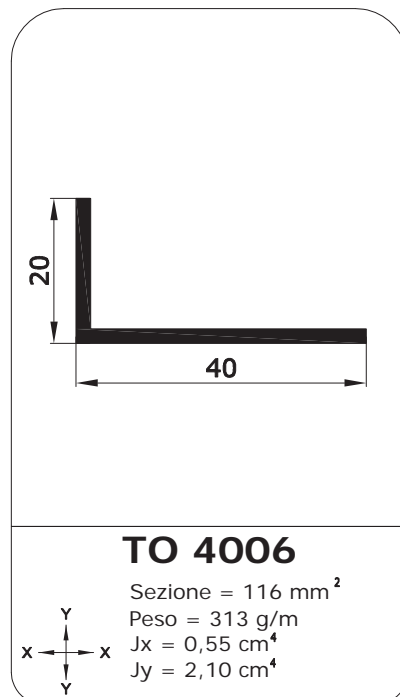
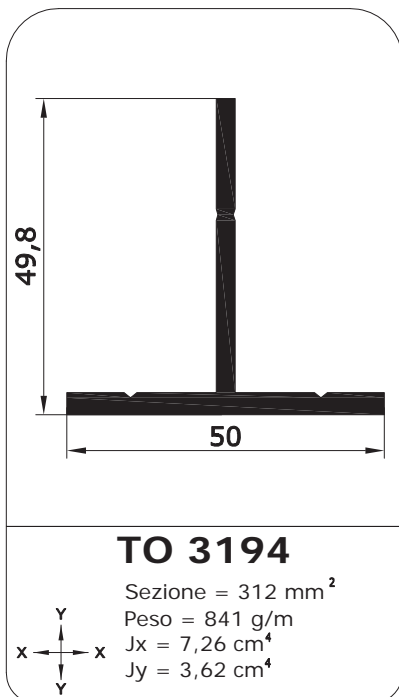

## SISTEMA DI MONTAGGIO A INCLINAZIONE VARIABILE

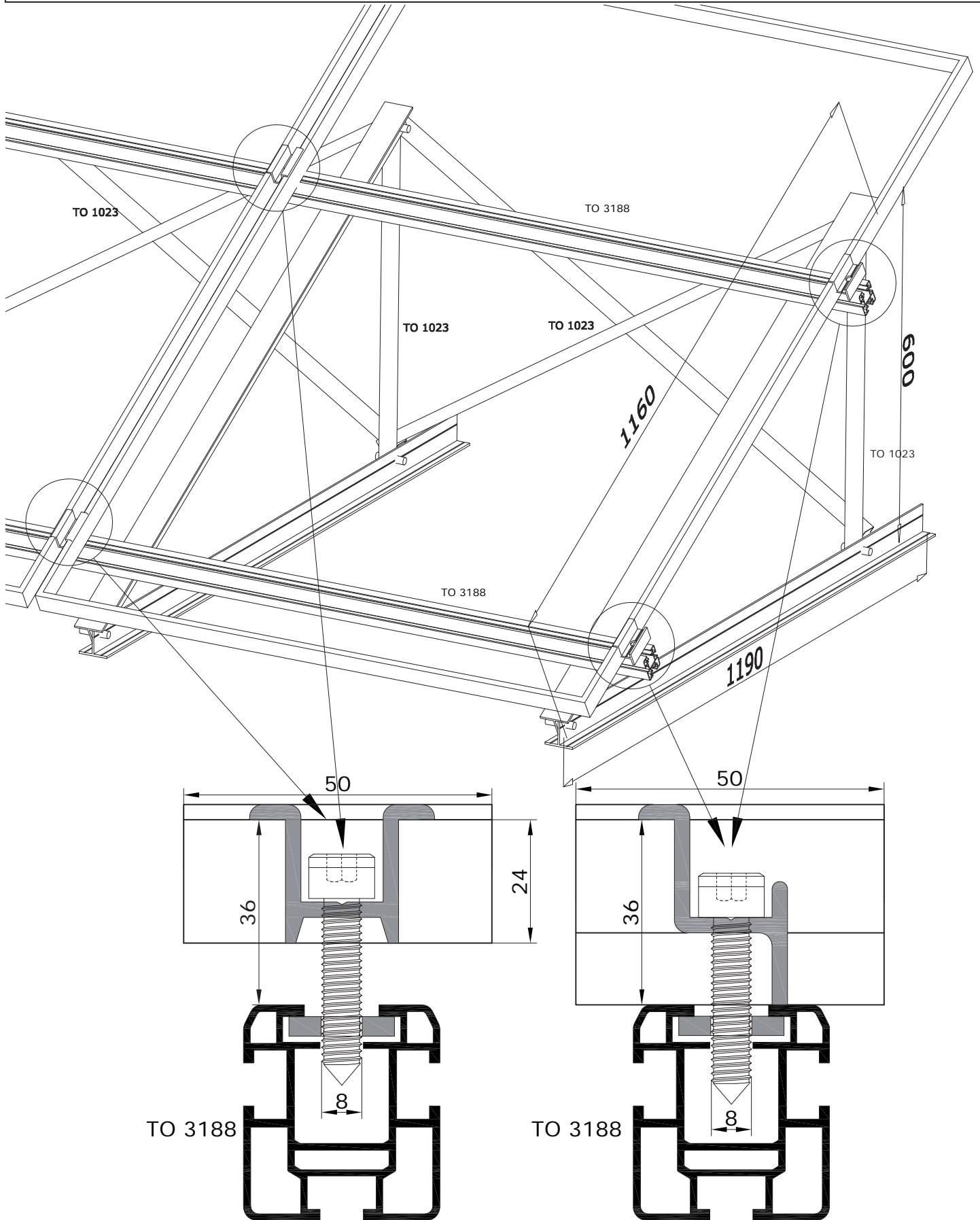

## ELENCO PROFILATI PER GAZEBO

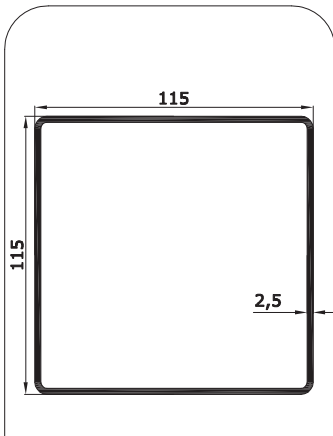

**CL 5115**

Sezione = 1109 mm<sup>2</sup>  
Peso = 2994 g/m  
Jx = 232,1 cm<sup>4</sup>  
Jy = 232,1 cm<sup>4</sup>

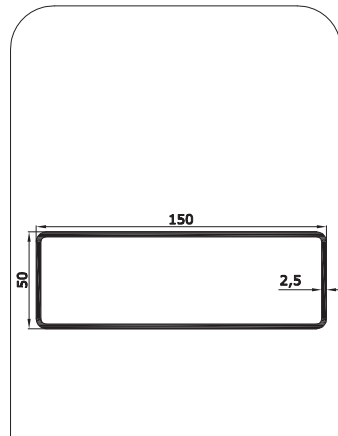

**CL 5106**

Sezione = 958 mm<sup>2</sup>  
Peso = 2586 g/m  
Jx = 45,17 cm<sup>4</sup>  
Jy = 254,0 cm<sup>4</sup>

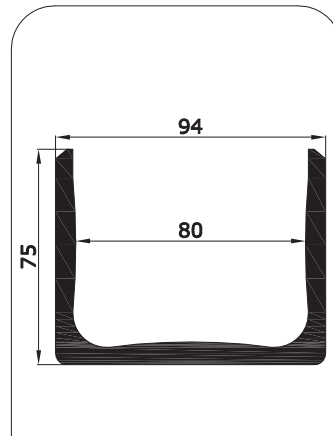

**CL 5113**

Sezione = 1571 mm<sup>2</sup>  
Peso = 4243 g/m  
Jx = 83,06 cm<sup>4</sup>  
Jy = 218,4 cm<sup>4</sup>

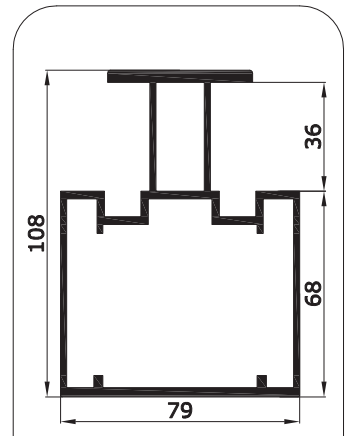

**CL 6319**

Sezione = 1141 mm<sup>2</sup>  
Peso = 3080 g/m  
Jx = 159,8 cm<sup>4</sup>  
Jy = 70,59 cm<sup>4</sup>

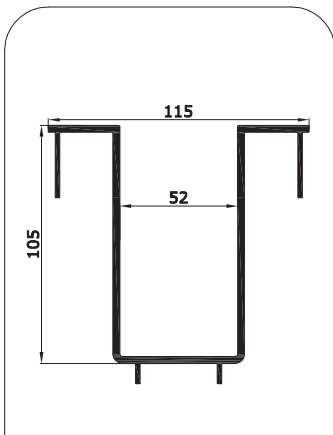

**CL 6105**

Sezione = 1102 mm<sup>2</sup>  
Peso = 2976 g/m

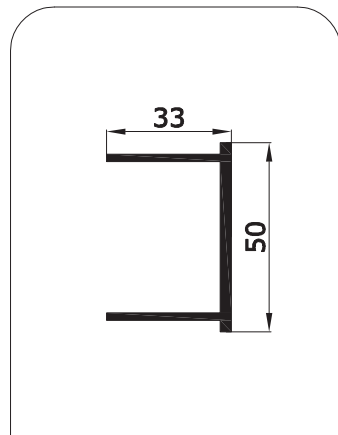

**CL 6108**

Sezione = 270 mm<sup>2</sup>  
Peso = 729 g/m

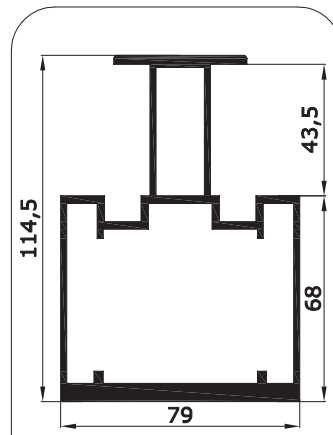

**CL 6311**

Sezione = 1352 mm<sup>2</sup>  
Peso = 3650 g/m  
Jx = 211,4 cm<sup>4</sup>  
Jy = 79,86 cm<sup>4</sup>

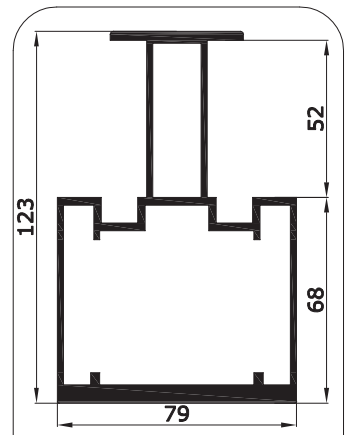

**CL 6258**

Sezione = 1386 mm<sup>2</sup>  
Peso = 3742 g/m  
Jx = 245,5 cm<sup>4</sup>  
Jy = 80,14 cm<sup>4</sup>

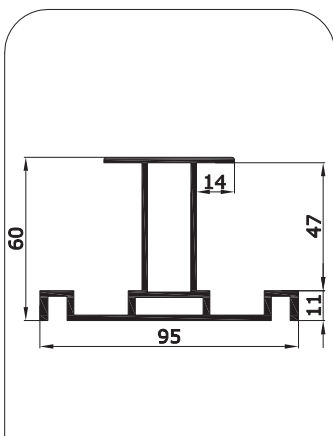

**CL 6375**

Sezione = 672 mm<sup>2</sup>  
Peso = 1815 g/m  
Jx = 31,34 cm<sup>4</sup>  
Jy = 36,14 cm<sup>4</sup>

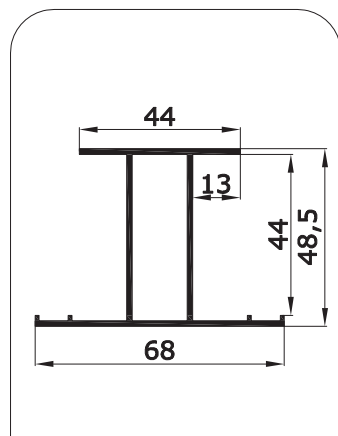

**CL 6341**

Sezione = 310 mm<sup>2</sup>  
Peso = 838 g/m  
Jx = 11,61 cm<sup>4</sup>  
Jy = 6,44 cm<sup>4</sup>

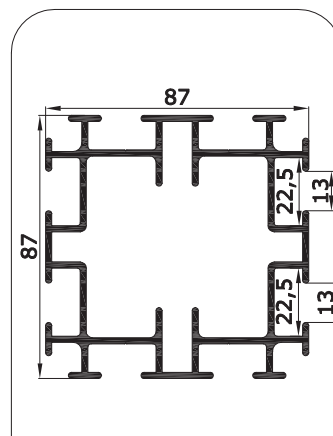

**CL 6278**

Sezione = 1168 mm<sup>2</sup>  
Peso = 3154 g/m  
Jx = 103,1 cm<sup>4</sup>  
Jy = 97,84 cm<sup>4</sup>

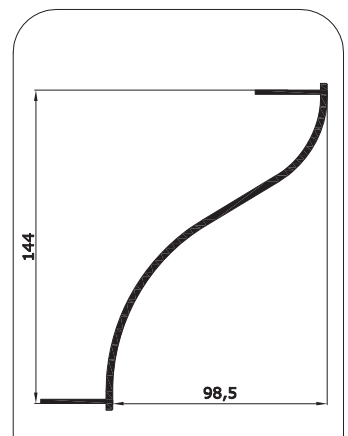

**CL 6104**

Sezione = 695 mm<sup>2</sup>  
Peso = 1878 g/m

## SISTEMA DI MONTAGGIO PER GAZEBO

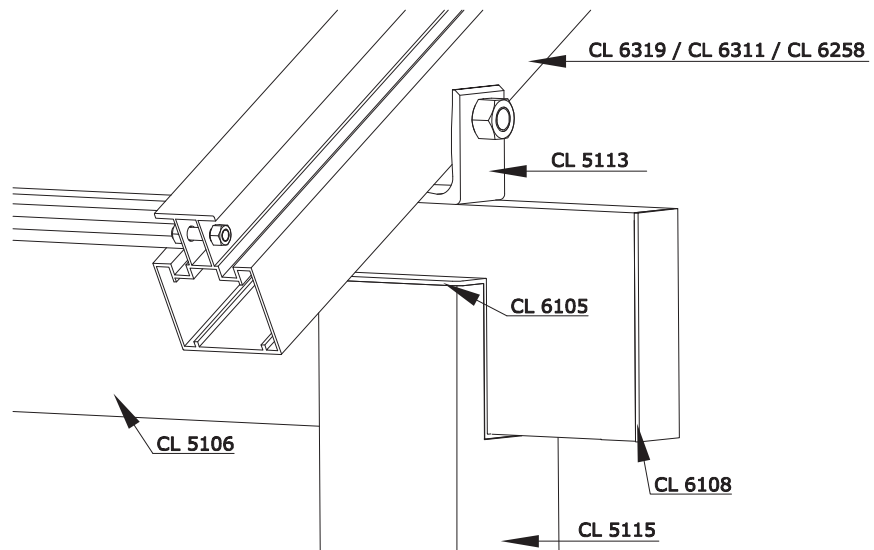
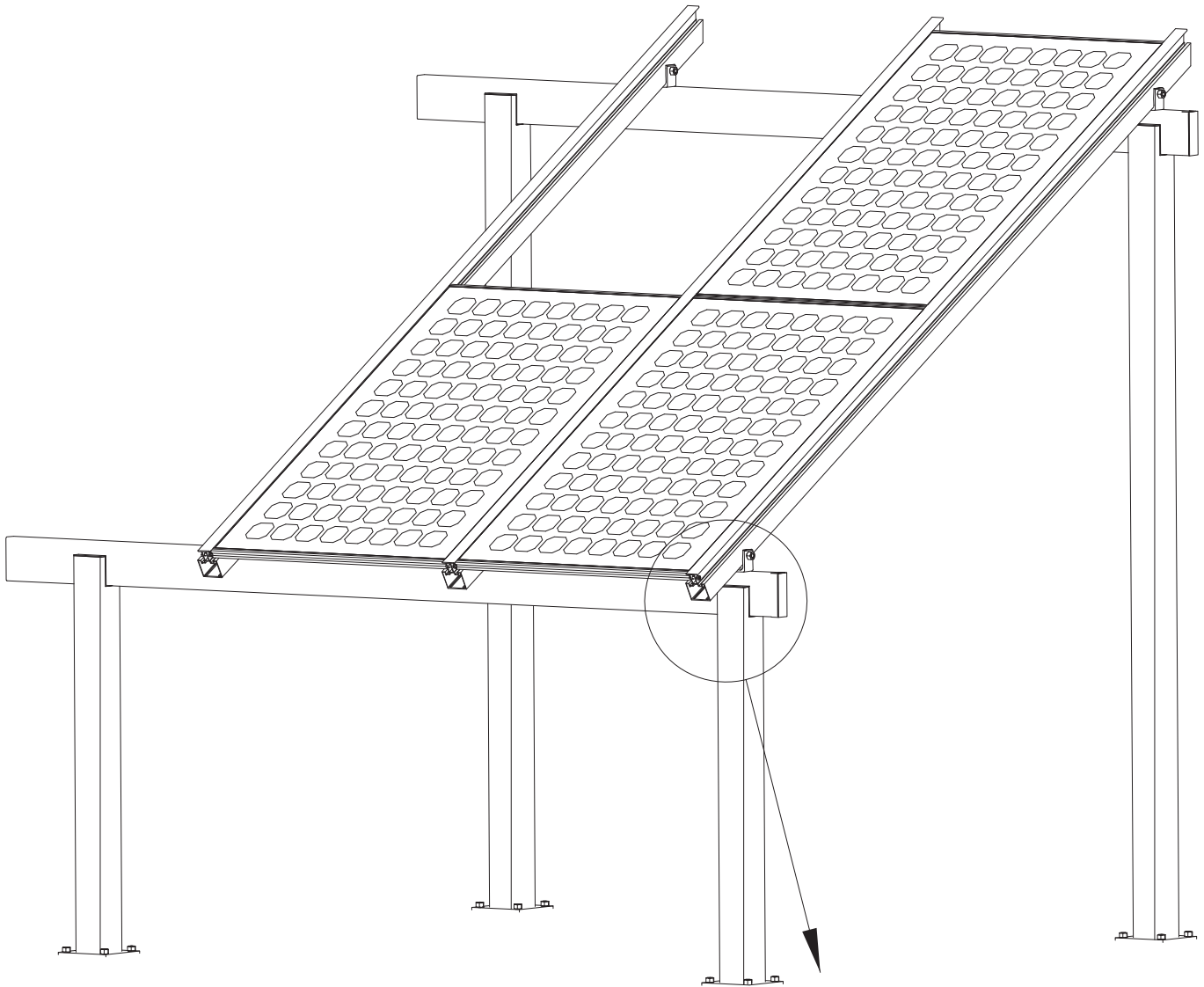



## SISTEMA DI MONTAGGIO PER GAZEBO

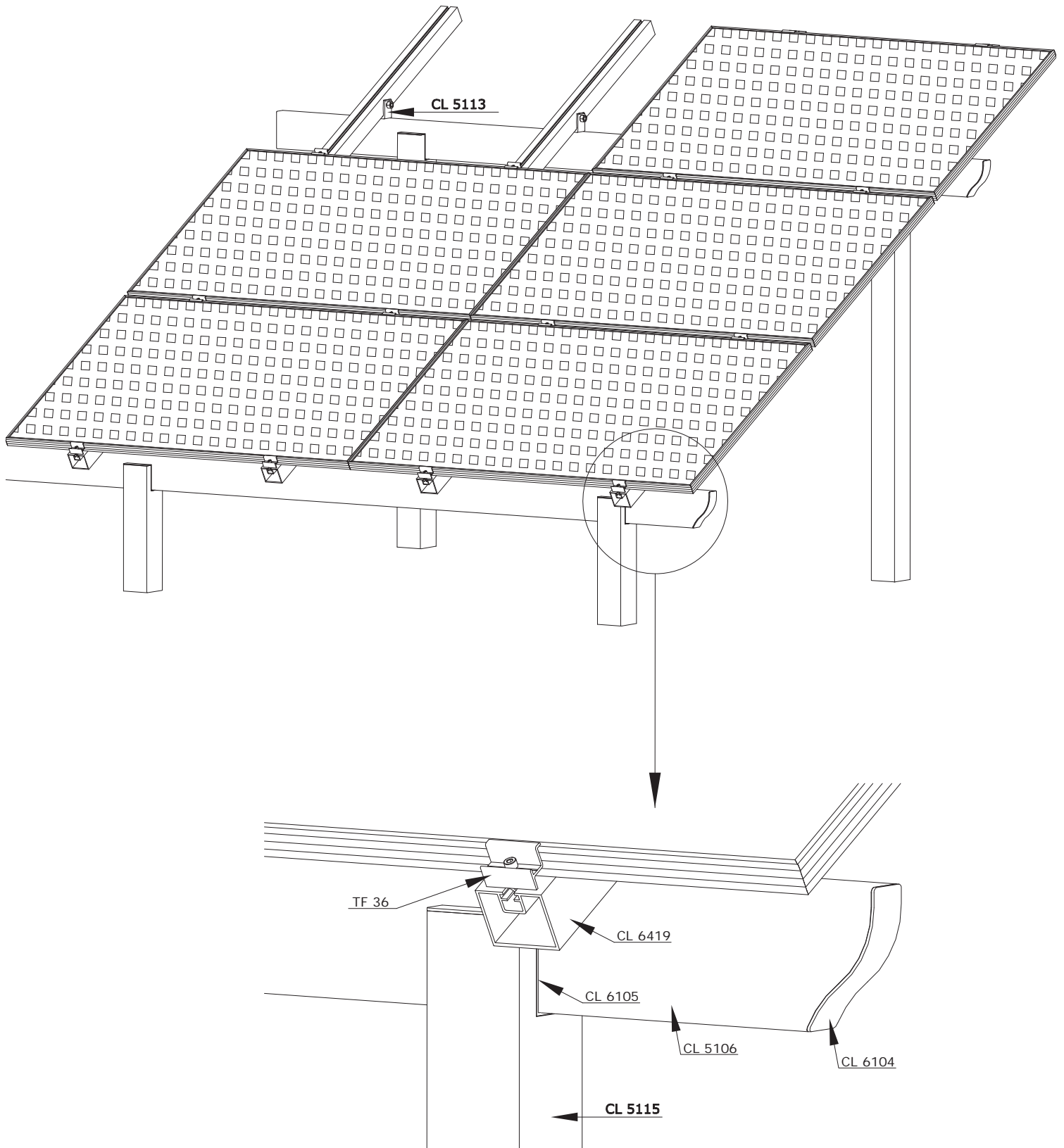

ELENCO PROFILATI PER STRUTTURE A TERRA  
MEDIANTE SOTTOSTRUTTURE METALLICHE

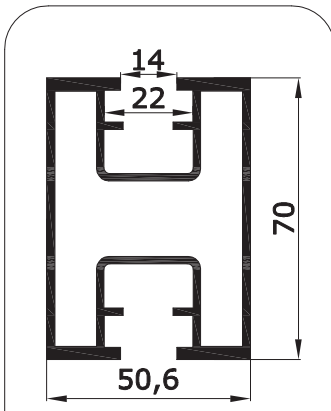

**CL 6504 \***

Sezione = 763 mm<sup>2</sup>  
Peso = 2060 g/m  
X X Jx = 45,26 cm<sup>4</sup>  
Y Y Jy = 24,77 cm<sup>4</sup>

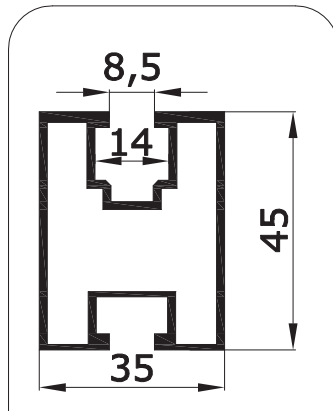

**CL 6506 \***

Sezione = 334 mm<sup>2</sup>  
Peso = 902 g/m  
X X Jx = 8,14 cm<sup>4</sup>  
Y Y Jy = 5,11 cm<sup>4</sup>

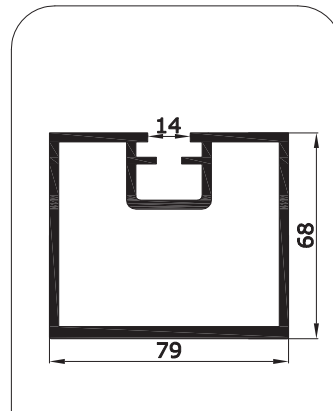

**CL 6419**

Sezione = 1104 mm<sup>2</sup>  
Peso = 2982 g/m  
X X Jx = 72,77 cm<sup>4</sup>  
Y Y Jy = 84,04 cm<sup>4</sup>

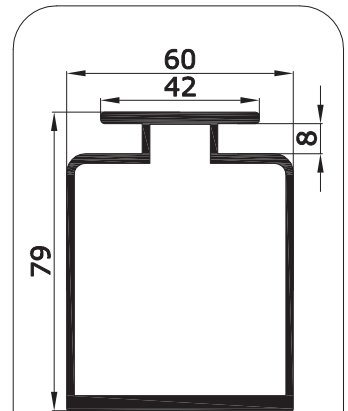

**CL 6490**

Sezione = 749 mm<sup>2</sup>  
Peso = 2023 g/m  
X X Jx = 71,31 cm<sup>4</sup>  
Y Y Jy = 33,77 cm<sup>4</sup>

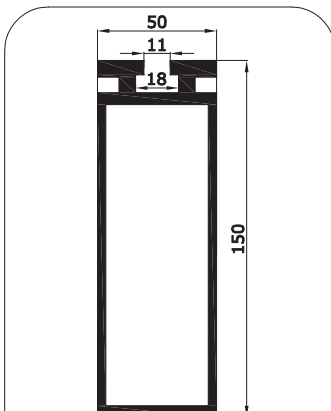

**CL 6491**

Sezione = 1742 mm<sup>2</sup>  
Peso = 4704 g/m  
X X Jx = 501,2 cm<sup>4</sup>  
Y Y Jy = 67,00 cm<sup>4</sup>

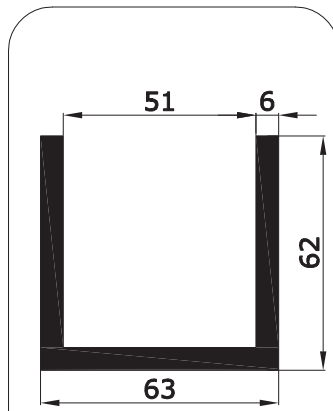

**TO 2004**

Sezione = 1050 mm<sup>2</sup>  
Peso = 2835 g/m  
X X Jx = 40,92 cm<sup>4</sup>  
Y Y Jy = 67,28 cm<sup>4</sup>

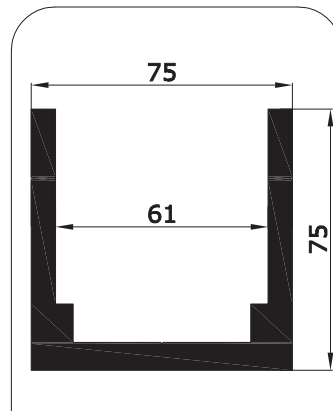

**CL 6492**

Sezione = 1647 mm<sup>2</sup>  
Peso = 4447 g/m  
X X Jx = 88,74 cm<sup>4</sup>  
Y Y Jy = 145,4 cm<sup>4</sup>

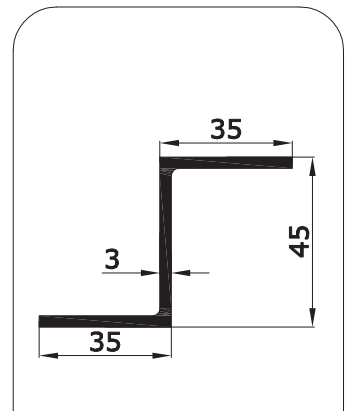

**TO 2051**

Sezione = 329 mm<sup>2</sup>  
Peso = 887 g/m  
X X Jx = 10,82 cm<sup>4</sup>  
Y Y Jy = 7,52 cm<sup>4</sup>

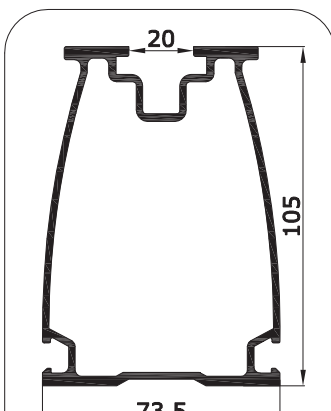

**CL 6400**

Sezione = 938 mm<sup>2</sup>  
Peso = 2534 g/m  
X X Jx = 152,6 cm<sup>4</sup>  
Y Y Jy = 63,15 cm<sup>4</sup>

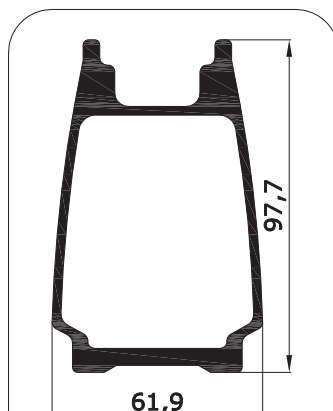

**CL 6401**

Sezione = 1148 mm<sup>2</sup>  
Peso = 3100 g/m  
X X Jx = 138,1 cm<sup>4</sup>  
Y Y Jy = 49,06 cm<sup>4</sup>

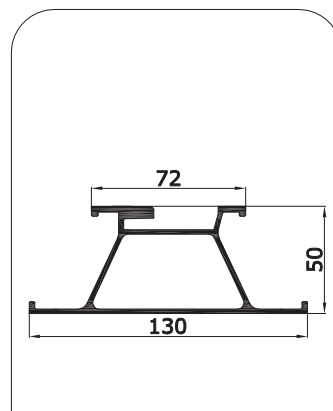

**CL 6485 \***

Sezione = 740 mm<sup>2</sup>  
Peso = 1998 g/m  
X X Jx = 29,16 cm<sup>4</sup>  
Y Y Jy = 72,55 cm<sup>4</sup>

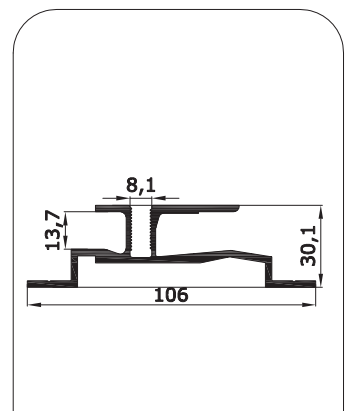

**CL 6435 \***

Sezione = 517 mm<sup>2</sup>  
Peso = 1395 g/m  
X X Jx = 4,83 cm<sup>4</sup>  
Y Y Jy = 34,67 cm<sup>4</sup>

## SISTEMA DI MONTAGGIO FISSATO A TERRA

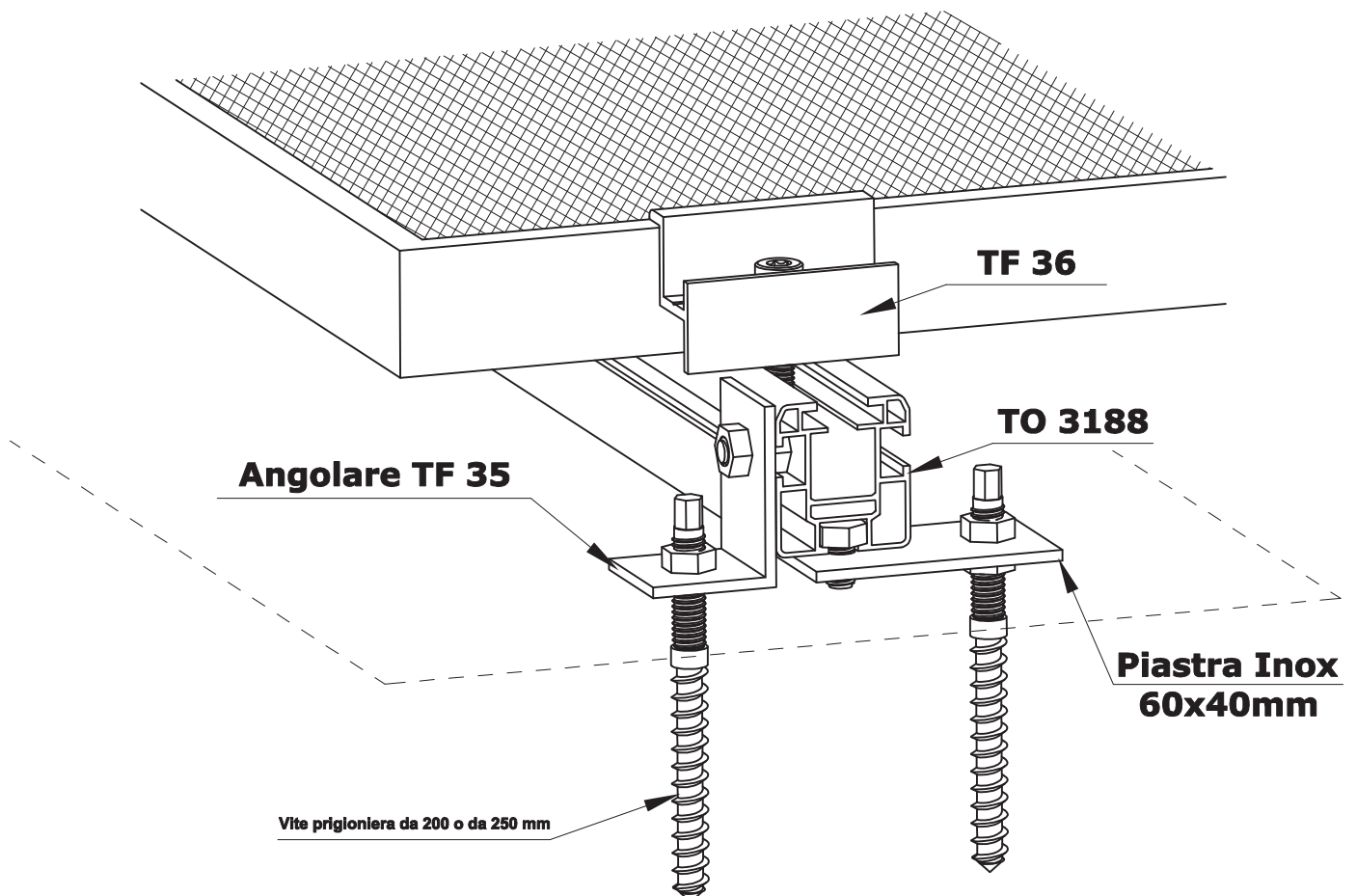
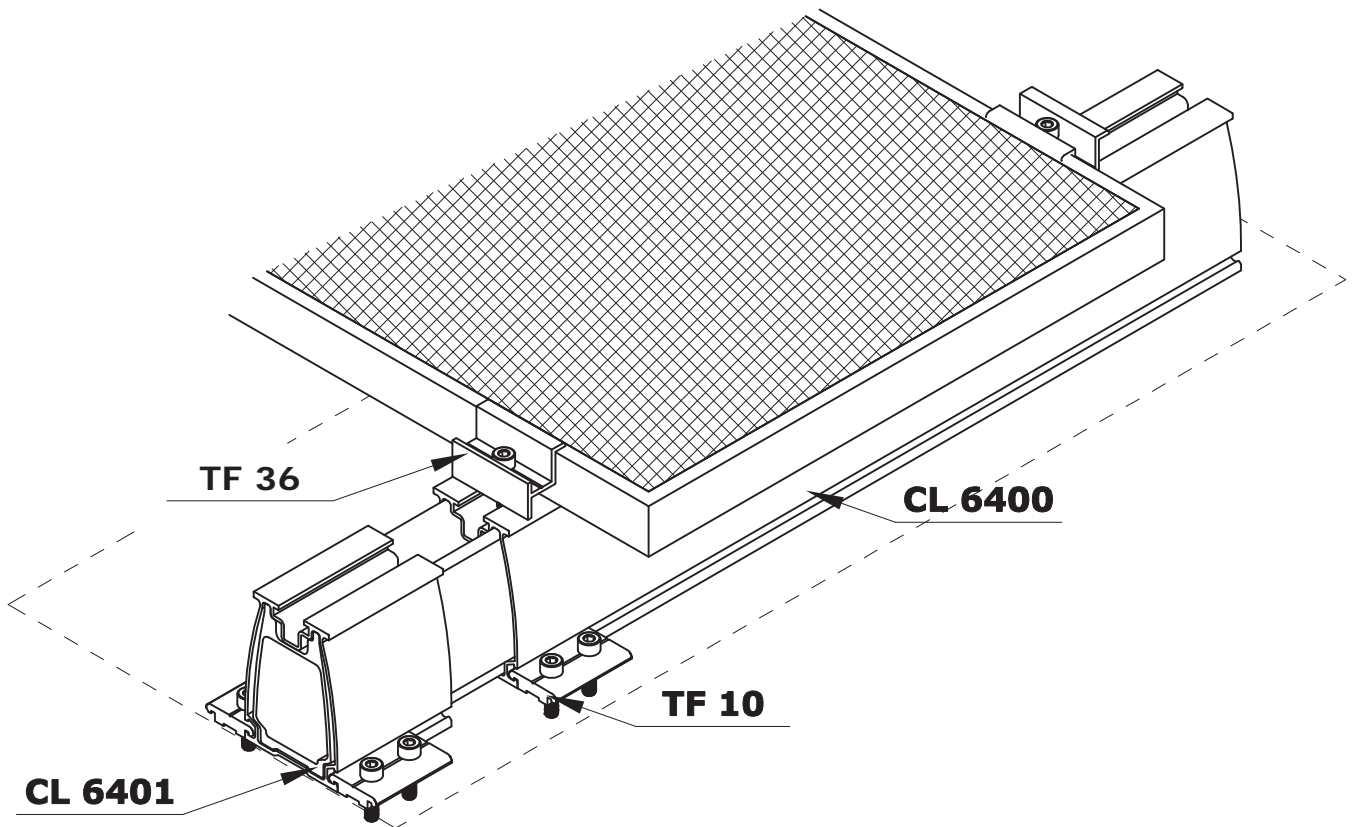

## SISTEMA DI MONTAGGIO SU SOTTOSTRUTTURA METALLICA

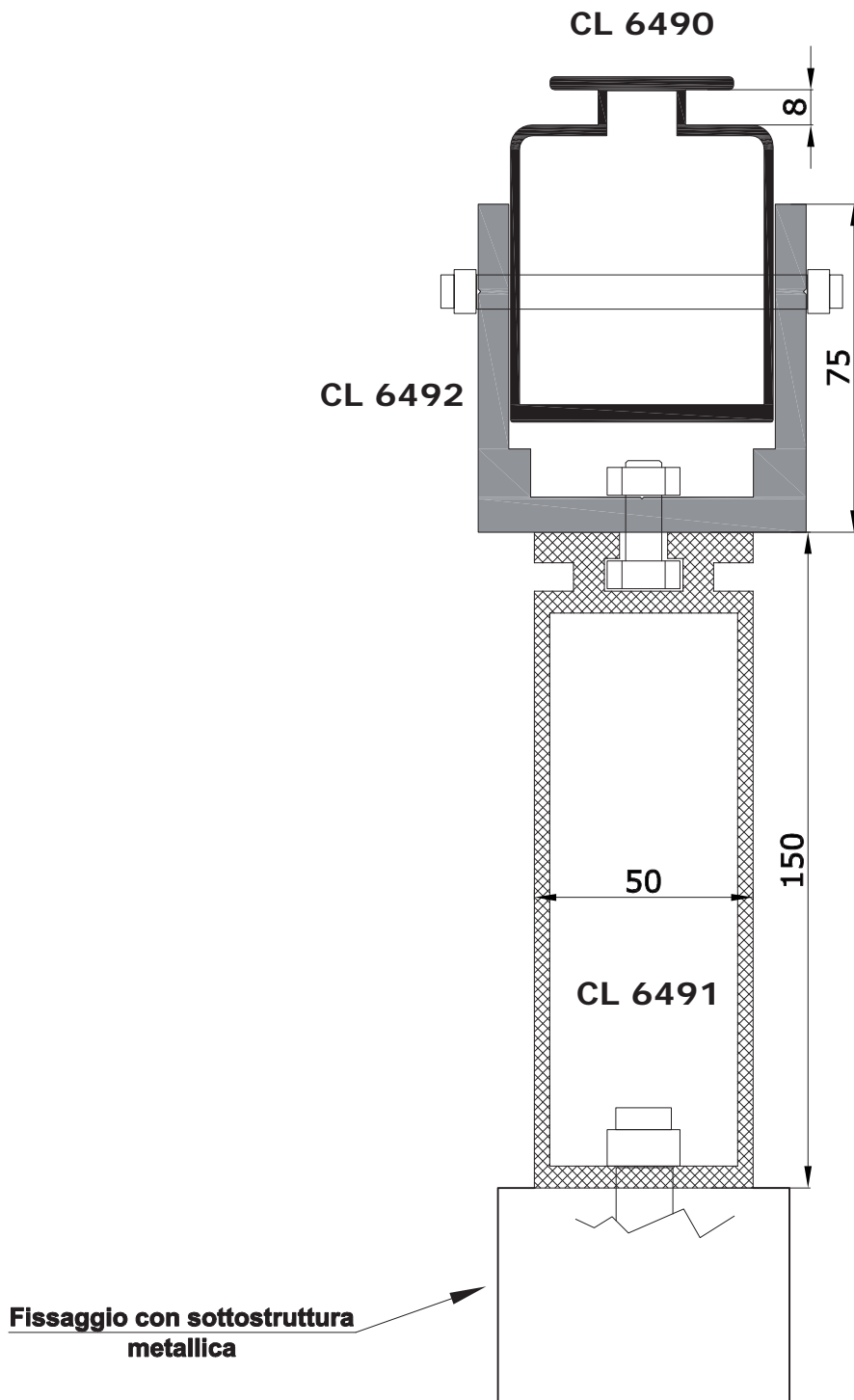

## ELENCO PROFILATI PER CHIUSURE ORIZZONTALI

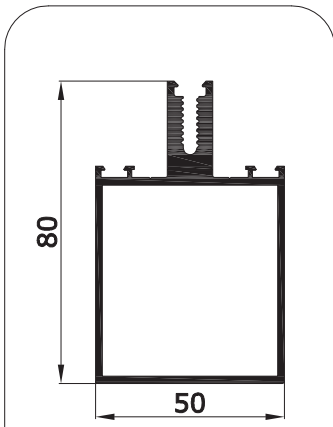

**AZ 9006**

Sezione = 615 mm<sup>2</sup>  
Peso = 1661 g/m  
Jx = 39,01 cm<sup>4</sup>  
Jy = 15,91 cm<sup>4</sup>

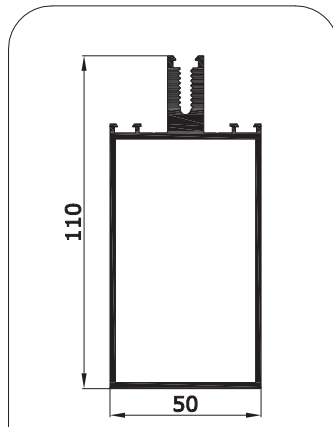

**AZ 9007**

Sezione = 723 mm<sup>2</sup>  
Peso = 1953 g/m  
Jx = 94,09 cm<sup>4</sup>  
Jy = 22,19 cm<sup>4</sup>

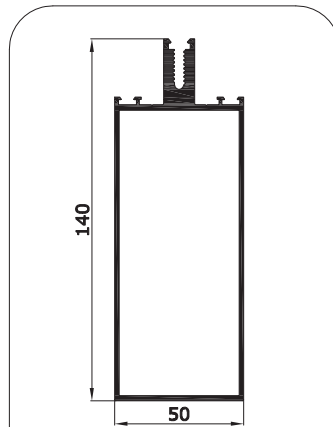

**AZ 9008**

Sezione = 831 mm<sup>2</sup>  
Peso = 2244 g/m  
Jx = 180,9 cm<sup>4</sup>  
Jy = 28,46 cm<sup>4</sup>

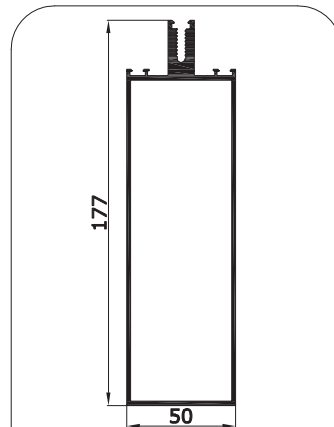

**AZ 9135**

Sezione = 964 mm<sup>2</sup>  
Peso = 2604 g/m  
Jx = 339,3 cm<sup>4</sup>  
Jy = 36,20 cm<sup>4</sup>

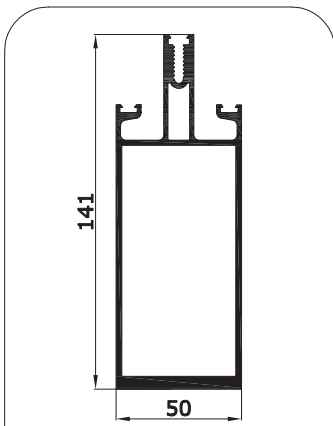

**AZ 9004**

Sezione = 1107 mm<sup>2</sup>  
Peso = 2989 g/m  
Jx = 245,5 cm<sup>4</sup>  
Jy = 36,81 cm<sup>4</sup>

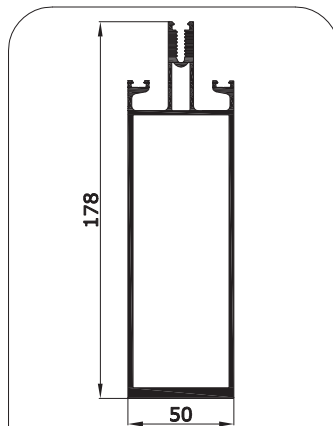

**AZ 9133**

Sezione = 1277 mm<sup>2</sup>  
Peso = 3449 g/m  
Jx = 460,3 cm<sup>4</sup>  
Jy = 46,50 cm<sup>4</sup>

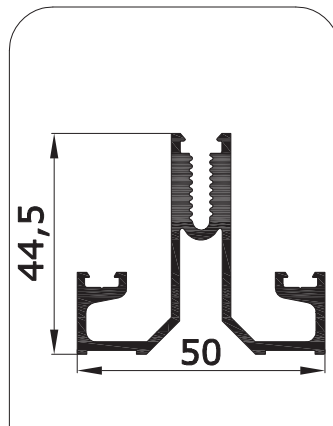

**AZ 9026**

Sezione = 399 mm<sup>2</sup>  
Peso = 1077 g/m

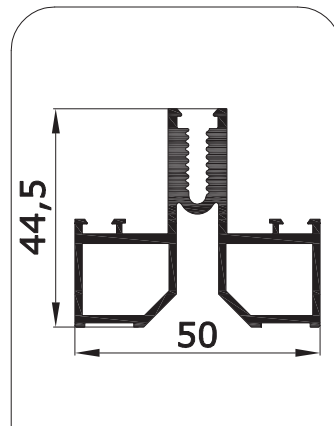

**AZ 9031**

Sezione = 421 mm<sup>2</sup>  
Peso = 1137 g/m

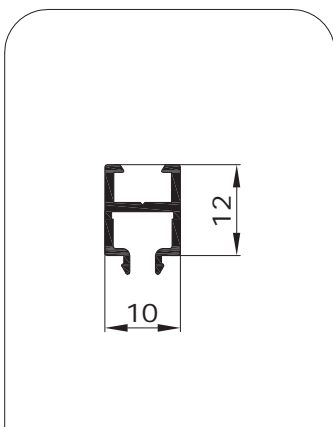

**AZ 9144**

Sezione = 46 mm<sup>2</sup>  
Peso = 124 g/m

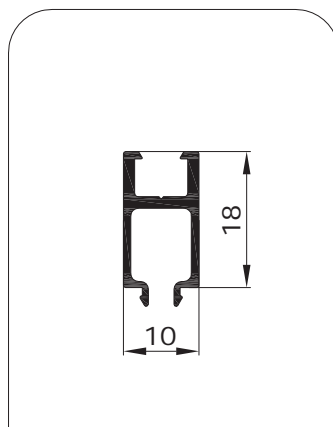

**AZ 9009**

Sezione = 63,6 mm<sup>2</sup>  
Peso = 172 g/m

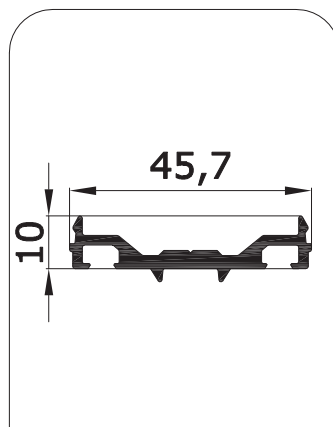

**AZ 9025**

Sezione = 165 mm<sup>2</sup>  
Peso = 445 g/m

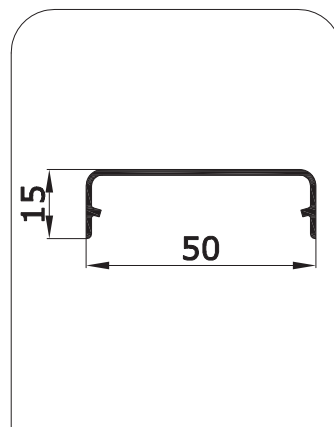

**AZ 9028**

Sezione = 95,7 mm<sup>2</sup>  
Peso = 258 g/m

## SISTEMA DI MONTAGGIO PER CHIUSURE ORIZZONTALI

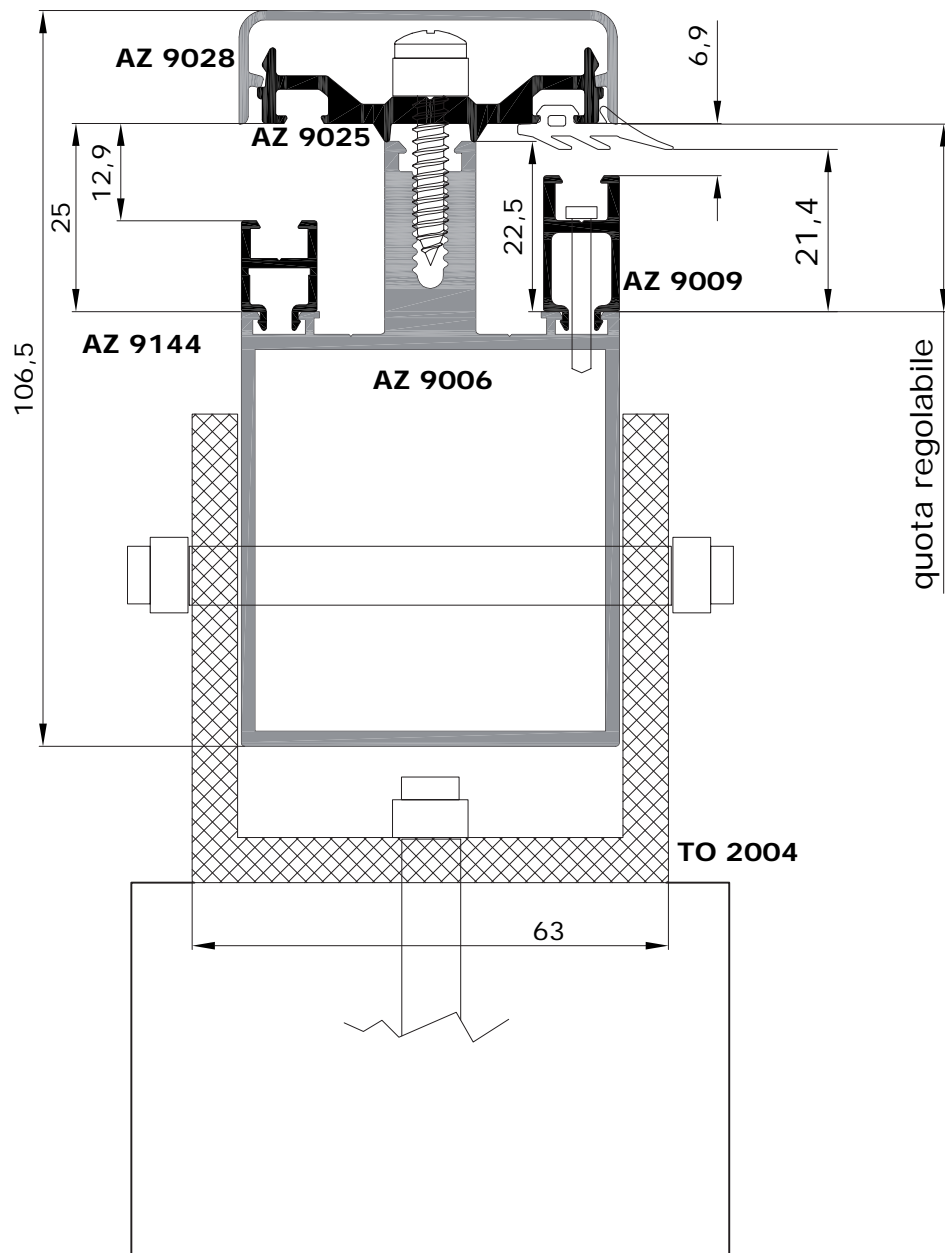

## Accessorio di tenuta centrale e laterale in alluminio

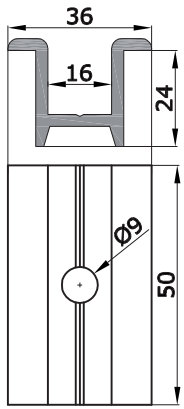

**TF 24**

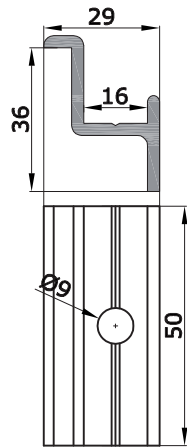
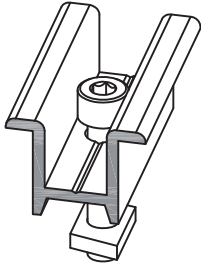

**TF 36**

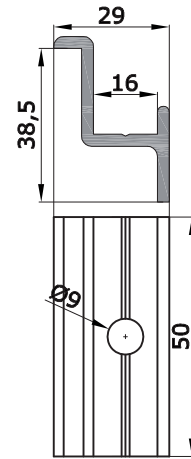
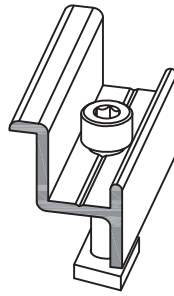

**TF 38**

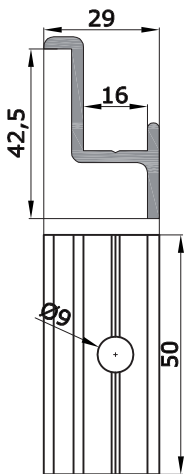
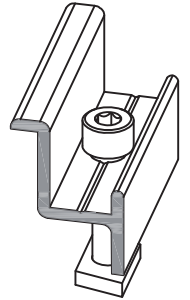

**TF 42**

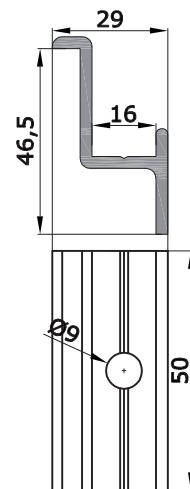
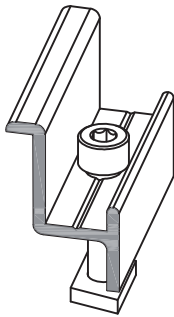

**TF 46**

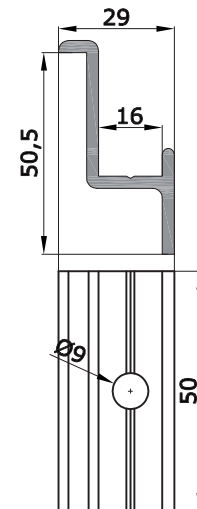
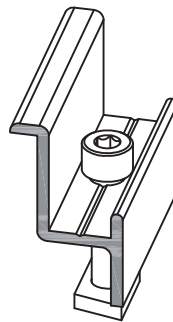

**TF 50**

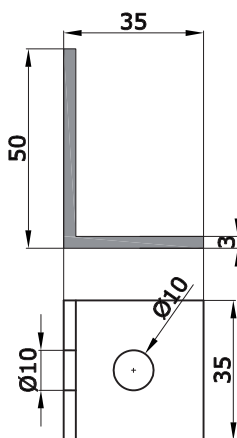
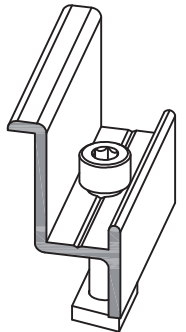

**TF 35**

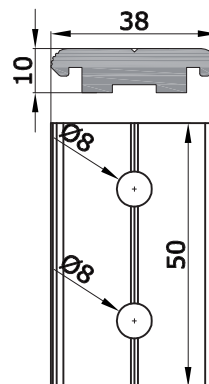
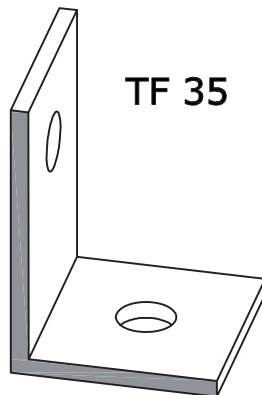

**TF 10**

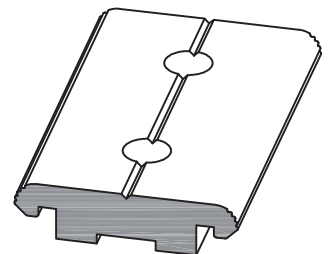



73036 Muro Leccese • s.s. 275 Maglie - Leuca  
Tel. 0836.444 083-4-5 • Fax 0836.444 532  
[info@tomalluminio.it](mailto:info@tomalluminio.it)